

Catchbox Beltpack Module



Third-party Transmitter Compatibility

The Catchbox Beltpack Module transforms a wireless beltpack transmitter into a throwable microphone for engaging audiences at large, supervised and managed events.

It features an integrated, focused omni-directional™ microphone element and is equipped with Automute™ technology, which automatically mutes the Module when in motion.

Adapter cables ensure compatibility with transmitters from various wireless microphone brands.

1. Make sure you have the right adapter cable to connect your third-party transmitter to the Beltpack Module

Two adapter cables are included with the Beltpack Module

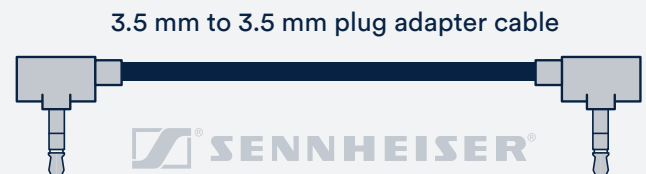
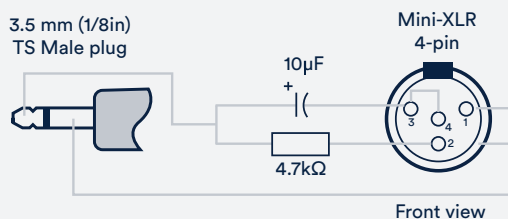

2. Check that your third-party transmitter size matches the Beltpack Module cavity dimensions.

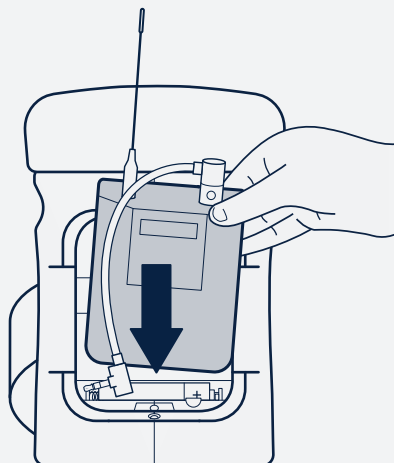

**Beltpack Module cavity dimensions -
87 × 68 × 27 mm / 3.4 × 2.7 × 1.06 in.**

Compatible Transmitters

Check the list to see if your third-party transmitter is compatible.

 Supported cables included in the package

 Supported cables available for purchase

SHURE

ULXD1
QLXD1
UR1M
GLXD1

SENNHEISER

SK 100 G3
SK 100 G3 1G8
SK 500 G3
SK 100 G2
SK 100 G4
SK 500 G4
SK 300 G4
SK 100 G4
XSW-D

AKG

PT470
PT420
PT45
PT40 mini
DPT800
DPT700
PT40 Pro
PT40 Flexx

MIPRO

ACT-70T
ACT-70TC
ACT-72T
ACT-71TA
ACT-72TC
ACT-50T
ACT-52T
ACT-52TC
ACT-30T
ACT-32T
ACT-32TC
ACT-80T
ACT-80TC
ACT-8Ta
ACT-24TC
ACT-24T

LECTROSONICS

UM400
LMb/E01
LT/E01
SMB/E01
SMDB/E01
LMB-B1

AUDIO TECHNICA

AEW-T1000
ATW-T1801
ATW-T310b
ATW-T210a

SONY

UTX-B03
UTX-B2
ZTX-B01
ZTX-B02RC



Note: If you don't see your transmitter model on the list, contact Catchbox customer support via Live Chat on our website or email us at info@catchbox.com